

Fords.

SALES | LETTINGS | NEW HOMES



193 Chairborough Road, High Wycombe, HP12 3UL

(Apartment 193)

Ford & Partners are proud to bring to market a recently renovated collection of just nine one-bedroom apartments situated in a purpose-built apartment building on the north-west side of High Wycombe's Town Centre.

The accommodation consists of one double bedroom, a bright and airy reception room, a stylish kitchen with appliances, modern family bathroom and storage.

NB: The photos are of the Show Apartment.

£1,200 Per month

- **Recently Refurbished Apartment**
- **One Double Bedroom**
- **New Electric Heating**
- **New UPVC Windows**
- **Ample Storage**
- **Modern Stylish Kitchen**
- **Modern Bathroom**
- **Blinds Included**
- **Appliances Included**
- **Residents Parking**

Chairborough Road, HP12 3UL

Approximate Gross Internal Area = 476 sq ft / 44.2 sq m



CH 2.26 = Ceiling Height

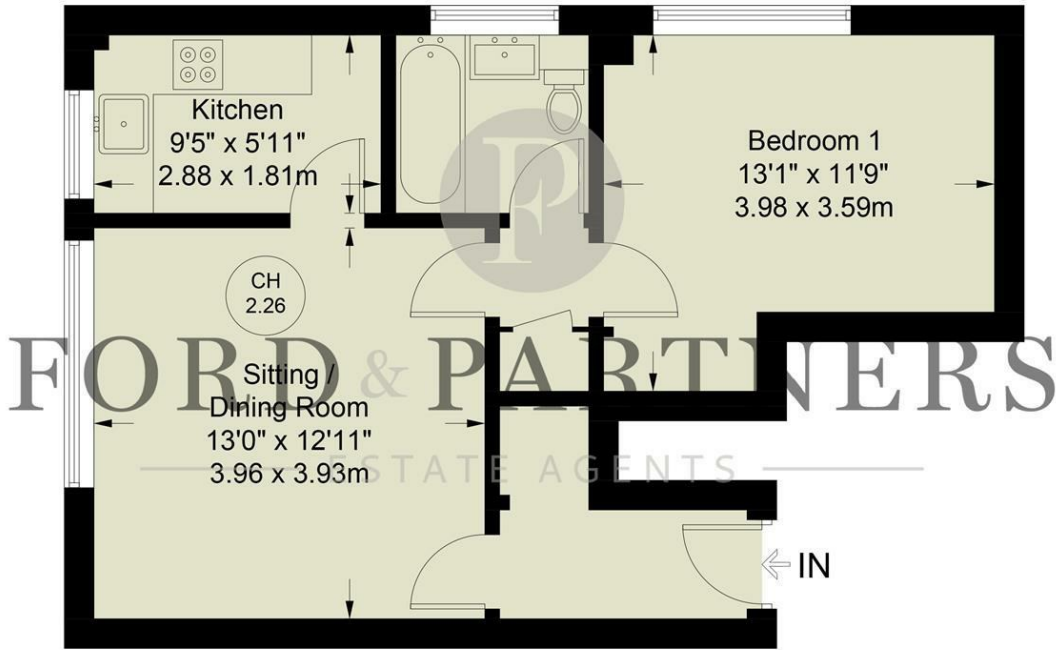

Floor Plan produced for Ford & Partners by Media Arcade ©.
 Illustration for identification purposes only. Window and door openings are approximate. Whilst every attempt is made to assure accuracy in the preparation of this plan, please check all dimensions, shapes and compass bearings before making any decisions reliant upon them.

| Energy Efficiency Rating | | Current | Potential |
|---|-------------------------|---------|-----------|
| Very energy efficient - lower running costs | | | |
| (92 plus) A | | | |
| (81-91) B | | | |
| (69-80) C | | | |
| (55-68) D | | | |
| (39-54) E | | | |
| (21-38) F | | | |
| (1-20) G | | | |
| Not energy efficient - higher running costs | | | |
| England & Wales | EU Directive 2002/91/EC | | |

| Environmental Impact (CO ₂) Rating | | Current | Potential |
|---|-------------------------|---------|-----------|
| Very environmentally friendly - lower CO ₂ emissions | | | |
| (92 plus) A | | | |
| (81-91) B | | | |
| (69-80) C | | | |
| (55-68) D | | | |
| (39-54) E | | | |
| (21-38) F | | | |
| (1-20) G | | | |
| Not environmentally friendly - higher CO ₂ emissions | | | |
| England & Wales | EU Directive 2002/91/EC | | |

